



## ZIP® rehab buggy

**Size 1** for children at the age of approx. 3 - 8 years

Crash tested according to ISO 7176-19 and ANSI/RESNA WC/Vol.1. - Section 19

Order form incl. Exportprices (€) valid until 31.12.2021, release date 01/2021

<input type="checkbox"/> Offer	<input type="checkbox"/> Order
Order number / reference	Date
<input type="text"/>	<input type="text"/>
<b>Invoice address</b>	
Company	Customer number
<input type="text"/>	<input type="text"/>
Street	City, Zip code
<input type="text"/>	<input type="text"/>
E-Mail	Telephone
<input type="text"/>	<input type="text"/>
Fax	
<input type="text"/>	
<b>Delivery address</b>	
Company	
<input type="text"/>	
Street	City, Zip code
<input type="text"/>	<input type="text"/>



### Basic configuration

#### Foldable compact rehab-buggy in a light aluminium construction

- Reinforced seat- and back cover
- Height adjustable footrest, angle adjustable and foldable
- Ball bearing rear and front wheels
- Wheel lock

#### Measurements:

Seat width	35 cm
Seat depth	30 / 35 cm
Back height	60 / 66 cm
Back recline	90° - 100°
Lower leg length	20 - 39 cm
Load capacity	50 kg
Weight	12,5 kg

#### Minimum information (Without this information your order can not be handled.)

<b>Frame colour:</b>	<input type="checkbox"/> Black <b>052</b>
<b>Nylon cover and Canopy:</b>	<input type="checkbox"/> Grey <b>304</b> <input type="checkbox"/> Black <b>320</b>
<b>Upholstery:</b>	<input type="checkbox"/> Black <b>306</b> <input type="checkbox"/> Red <b>314</b> <input type="checkbox"/> Pink <b>336</b> <input type="checkbox"/> Turquoise <b>335</b>
<b>Accessories:</b>	<input type="checkbox"/> Iron grey <b>323</b>
<b>Presettings</b> (At missing specifications we will adjust to medium sizes.)	
<b>Seat depth:</b>	<input type="checkbox"/> 30 cm <input type="checkbox"/> 35 cm
<b>Back height:</b>	<input type="checkbox"/> 60 cm <input type="checkbox"/> 66 cm
<b>Lower leg length:</b>	<input type="checkbox"/> (20 - 39 cm)

**Basic variations**

with/or: Please choose one version, only!

	Orderno.	Colour	Description	Qty.	Price
	<input type="checkbox"/> 3210-0001		<b>ZIP® size 1 with back height 60 cm</b>	<b>1 pc.</b>	
and	<input checked="" type="checkbox"/> 3210-2101		Reinforced nylon cover, back height 60 cm	<b>01</b> 1 set	incl.
	<input type="checkbox"/> 3210-0002		<b>ZIP® size 1 with back height 66 cm</b>	<b>1 pc.</b>	
and	<input checked="" type="checkbox"/> 3210-2102		Reinforced nylon cover, back height 66 cm	1 set	incl.
	<input type="checkbox"/> 3210-8501		Recline angle extension 120°	<b>02</b> 1 pc.	
and	<input checked="" type="checkbox"/> 3210-2103		Reinforced nylon cover (120°) back height 60 cm	1 set	incl.
and	<input checked="" type="checkbox"/> 3210-2104		Reinforced nylon cover (120°) back height 66 cm	1 set	incl.
with	<input type="checkbox"/> 1281-1007		Plastic front forks	<b>03</b> 1 set	incl.
	<input type="checkbox"/> 3202-7100		Swivel lock for Plastic front forks	<b>04</b> 1 set	
or	<input type="checkbox"/> 1281-1008		Aluminum front forks	<b>(upcharge) 05</b> 1 set	
	<input type="checkbox"/> 3232-7100		Swivel lock for Aluminum front forks	1 set	
with	<input type="checkbox"/> 1229-0008S		Polyurethan tires with 6-spoke rims	<b>06</b> 1 set	incl.
or	<input type="checkbox"/> 1229-0010		Polyurethan wheels with 7-spoke rims	<b>07</b> 1 set	incl.
or	<input type="checkbox"/> 1219-0004S		Pneumatic tires with 6-spoke rims	<b>08</b> 1 set	incl.
with	<input type="checkbox"/> 3210-2410	015	Foot board assembly height adjustable, angle adjustable, foldable	<b>09</b> 1 set	incl.
or	<input type="checkbox"/> 3210-2510	015	Foot board assembly straight angle adjustable, foldable, swing away	<b>(upcharge) 10</b> 1 set	
with	<input type="checkbox"/> 3210-7300		Tie down kit ISO 7176-19	<b>11</b> 1 set	

**Accessories**

	Orderno.	Colour	Description	Qty.	Price
	<input type="checkbox"/> 3202-7100		Retrofit kit Swivel lock for Plastic front forks	<b>04</b> 1 set	
	<input type="checkbox"/> 3232-7100		Retrofit kit Swivel lock for Aluminum front forks	1 set	
	<input type="checkbox"/> 3210-7201		Attendant brake, two hand use	<b>12</b> 1 set	
	<input type="checkbox"/> 3210-7300E		Tie down kit, retrofit	1 set	
	<input type="checkbox"/> 3210-5000		Foldable back rest upholstery, height 60 cm	<b>13</b> 1 pc.	
	<input type="checkbox"/> 3210-5100		Foldable back rest upholstery, height 66 cm	1 pc.	
	<input type="checkbox"/> 3210-5200		Foldable seat upholstery	<b>14</b> 1 pc.	
	<input type="checkbox"/> 3210-7600		Headrest	<b>15</b> 1 pc.	
	<input type="checkbox"/> 3210-7800		Abduction block, size 2, swing away and detachable	<b>16</b> 1 pc.	
	<input type="checkbox"/> 3213-7800		Abduction block, size 3, swing away and detachable	1 pc.	
	<input type="checkbox"/> 3210-5300		Groin strap, size 1	<b>17</b> 1 pc.	
	<input type="checkbox"/> 3210-5400		Groin strap, size 2	1 pc.	
	<input type="checkbox"/> 3201-6100		Lap belt	<b>18</b> 1 pc.	
	<input type="checkbox"/> 3213-6200		Five-point harness	<b>19</b> 1 pc.	
	<input type="checkbox"/> 3201-6400		Ankle hugger, size 1	<b>20</b> 1 pair	
	<input type="checkbox"/> 3203-6400		Ankle hugger, size 2	1 pair	
	<input type="checkbox"/> 3210-8100		Grap rail with upholstery, size 1	<b>21</b> 1 pc.	
	<input type="checkbox"/> 3210-5500	306	Calf strap with upholstery, black	<b>22</b> 1 pc.	
	<input type="checkbox"/> 3210-8201		Therapy tray, size 1, grey	<b>23</b> 1 pc.	
	<input type="checkbox"/> 3210-8203		Therapy tray, size 1, grey, height adjustable	1 pc.	
	<input type="checkbox"/> 3210-8200		Therapy tray, size 1, transparent	<b>24</b> 1 pc.	
	<input type="checkbox"/> 3210-8202		Therapy tray, size 1, transparent, height adjustable	1 pc.	
	<input type="checkbox"/> 3201-8400	323	Winter warmer, size 2, iron grey	<b>25</b> 1 pc.	
	<input type="checkbox"/> 3203-8300	323	Winter warmer, size 3, iron grey	1 pc.	
	<input type="checkbox"/> 7000-0019		Sheep skin insert, size 2	<b>26</b> 1 pc.	
	<input type="checkbox"/> 7000-0020		Sheep skin insert, size 3	1 pc.	
	<input type="checkbox"/> 3203-9200	323	Rain cape, size 2, iron grey	<b>27</b> 1 pc.	
	<input type="checkbox"/> 3210-9300		Canopy incl. adapter and rain cover	<b>28</b> 1 pc.	

**Extra equipment**

	Orderno.	Colour	Description	Qty.	Price
	<input type="checkbox"/> 7000-0010		Buggy-Board	<b>29</b> 1 pc.	
	<input type="checkbox"/> 7000-0012	304	Sun shade with fasteners, grey	<b>30</b> 1 pc.	
	<input type="checkbox"/> 3210-9500		Nylon bag for transport	<b>31</b> 1 pc.	
	<input type="checkbox"/> 7000-0058	306	Accessories and diaper bag, black	<b>32</b> 1 pc.	
	<input type="checkbox"/> SA-0260-KP		Tip assist for ZIP	<b>33</b> 1 pc.	
	<input type="checkbox"/> SA-0046-MP		Nylon seat with additional holes for seat depth 25 cm	1 pc.	

# CONFIGURATIONS // ACCESSORIES // ZIP



01 Reinforced nylon cover



02 Recline angle extension 120°



03 Plastic front forks



04 Swivel lock



05 Aluminum front forks



06 Polyurethan tires with 6-spoke rims



07 Polyurethan tires with 6-spoke rims



08 Polyurethan wheels with 7-spoke rims



09 Polyurethan wheels with 7-spoke rims



10 Pneumatic tires with 6-spoke rims



11 Pneumatic tires with 6-spoke rims



12 Foot board assembly



13 Foot board assembly straight



14 Tie down kit



15 Attendant brake, two hand use



16 Back rest upholstery



17 Seat upholstery



18 Headrest



19 Abduction block



20 Groin strap



21 Lap belt



22 Five-point harness



23 Ankle huger



24 Grap rail with upholstery



25 Calf strap with upholstery

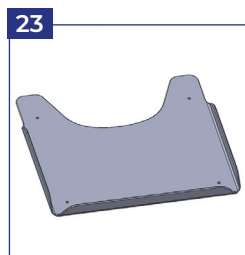

26 Therapy tray, grey



27 Therapy tray, transparent



28 Winter warmer



29 Sheep skin



30 Rain cape

# CONFIGURATIONS // ACCESSORIES // ZIP



28 Canopy incl. transparent rain cover



29 Buggy-Board



30 Sun shade



31 Nylon bag for transport



32 Accessory and diaper bag



33 Tip assist